

EXISTING PARKING LOT AND ROADWAYS

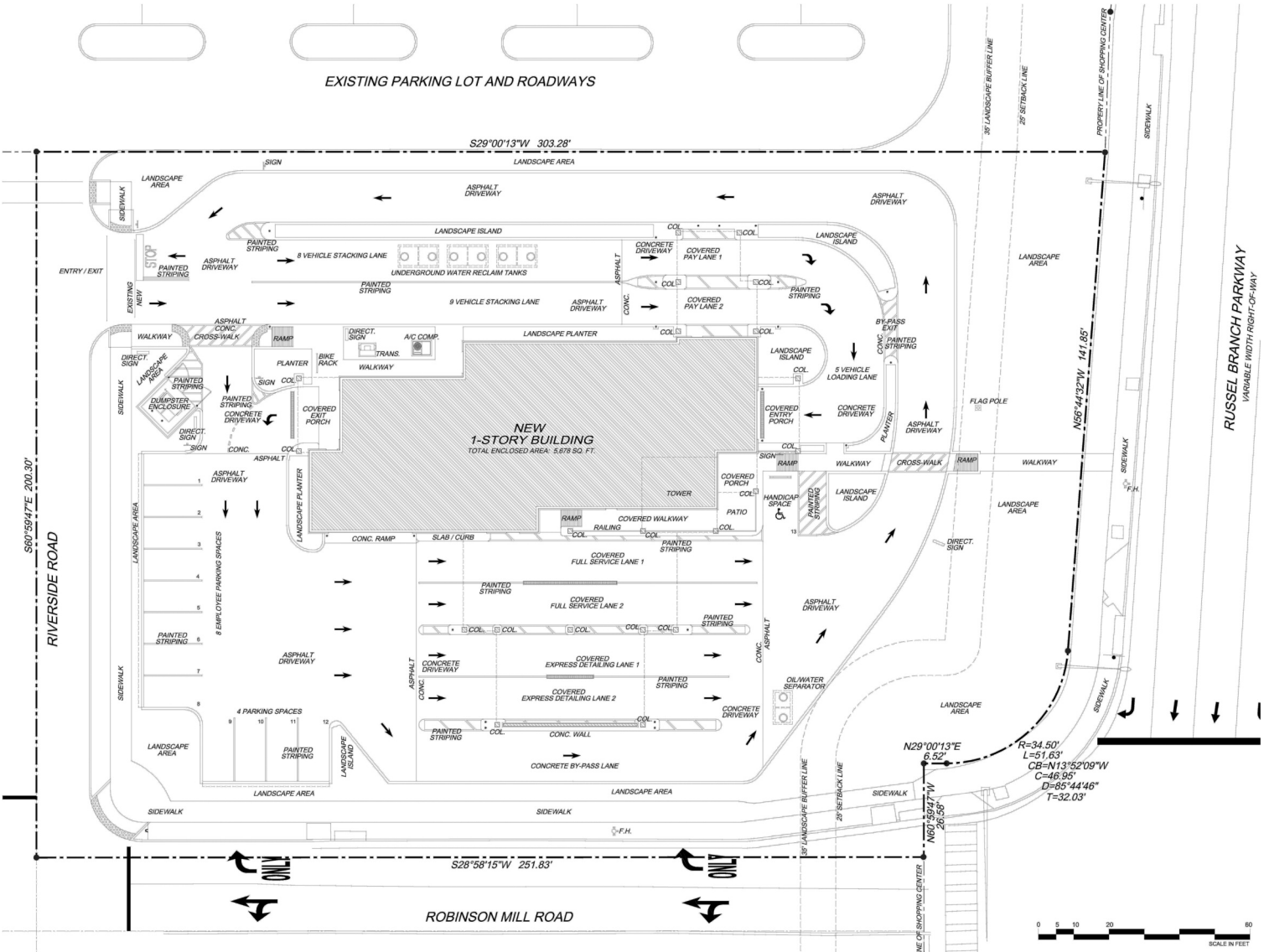

S29°00'13"W 303.28'

LANDSCAPE AREA

NEW 1-STORY BUILDING  
TOTAL ENCLOSED AREA: 5,878 SQ. FT.

S28°58'15"W 251.83'

ROBINSON MILL ROAD

N29°00'13"E 8.52'  
N60°59'47"W 26.58'  
R=34.50'  
L=51.63'  
CB=N13°52'09"W  
C=46.95'  
D=85°44'46"  
T=32.03'



RUSSEL BRANCH PARKWAY  
VARIABLE WIDTH RIGHT-OF-WAY

S60°59'47"E 200.30'  
RIVERSIDE ROAD

N56°44'32"W 141.85'

PROPERTY LINE OF SHOPPING CENTER

F.H.

LINE OF SHOPPING CENTER